

323Du/RL and 323Du/RL2

Metering and Transfer Pump
 Digital/Auto/Manual Control
 IP31 Wipedown Enclosure



Technical Information and Features

- Flow rates from 0.06 to 2200 mL/min (0.0009-34.8 gph)
- Operator friendly keypad offering:
 - Start, stop, speed control, fwd/rev, control mode
 - Precise manual speed control from 1.5-220 rpm in 1 rpm increments
 - Large clear LCD display with accurate digital monitoring for clear RPM indication
 - “Auto-restart” and “keypad lock” functions
 - Memo Dose feature allows manually actuated repetitive discrete volume dispensing
- 147:1 speed control range
- Remote speed control via 0-10VDC or 4-20mA analog speed input when in Analog mode
- Remote start/stop capability via dry contact closure or TTL switching
- Remote direction control capability via dry contact closure or TTL switching
- RS232 signal interface capability
- Tough metal and ABS case with broad chemical resistance and IP31 wipedown enclosure
- Brushless DC motor for excellent speed control, quiet operation, and no maintenance
- Standard with easy loading twin sprung roller 501RL pumphead or 501RL2 for thick wall tubing
- 501RL accepts tube sizes # 112, 13, 14, 16, 25, 17, and 18 (0.5-8.0 mm bore & 1.6 mm wall)
- 501RL2 accepts thick wall tube sizes # 105, 108, 119, 120, 15, 24, 121 (0.5-8.0 mm bore & 2.4 mm thick wall)

Flow Rate Ranges (ml/min*)

	112	13	14	16	25	17	18
1.6 mm Wall Tube #	112	13	14	16	25	17	18
2.4 mm Wall Tube #	105	108	119	120	15	24	121
Tube Bore	0.5mm 1/50"	0.8mm 1/32"	1.6mm 1/16"	3.2mm 1/8"	4.8mm 3/16"	6.4mm 1/4"	8.0mm 5/16"
1.5-220 rpm	0.06-9.2	0.18-27	0.64-94	2.8-410	6.1-890	9.5-1400	15-2200

* 1 gal = 3785.4 ml

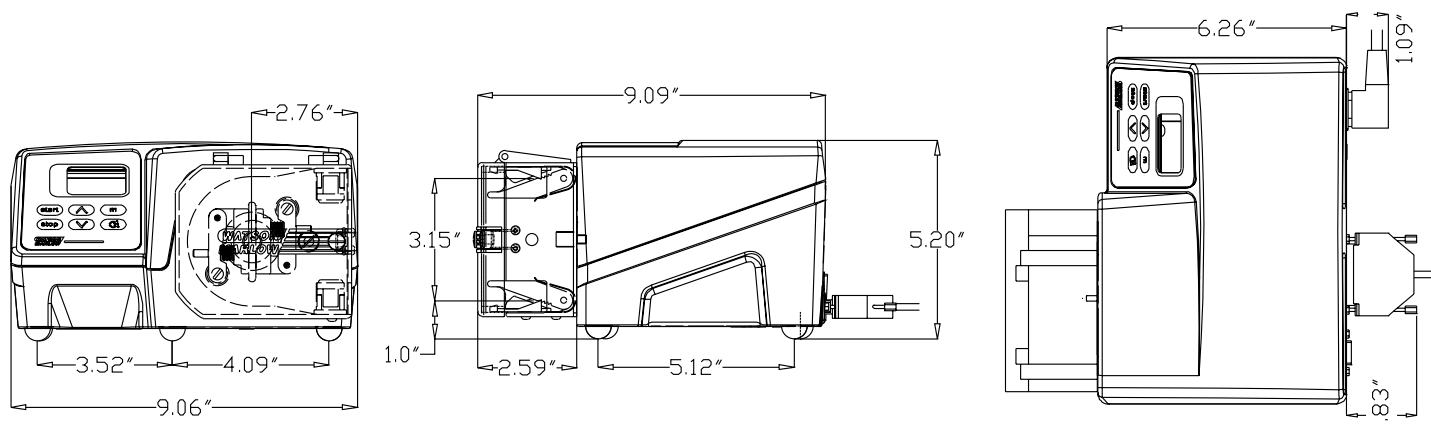

323Du/RL and 323Du/RL2

Metering and Transfer Pump

Digital/Auto/Manual Control - IP31 Wipedown Enclosure

Specifications

Shipping Weight: 12.1 lbs
Maximum Power Consumption: 100VA
Supply: 100-120/220-240V 50-60Hz (voltage selectable)
Maximum Rotor Speeds: 220 rpm
Enclosure: IP31 wipedown
Operational Temperature Range: 4°C to 40°C (40°F to 104°F)
Control Range: 147:1
Noise: <70dBA at 1 meter
Standards: Equipment complies with all applicable CE directives

Product Codes

323Du Drive, 220 rpm	036.3152.00A
501RL pumphead for 1.6 mm wall	053.0001.L00
501RL2 pumphead for 2.4 mm wall	053.0001.L20
Complete 323Du/RL	030.3152.RLA
Complete 323Du/RL2	030.3152.R2A

Materials of Construction

Pumphead
Pump Track: Epoxy coated Mazak casting, Delrin hinges, Delrin tube clamps
Rotor: Chrome plated Mazak casting, stainless steel collet and fittings, Nylatron rollers, Delrin guide rollers
Guard: Polycarbonate
Drive
Drive Base: Powder coated aluminum casting
Drive Top: ABS Plastic

Available Tubing Materials

1.6 mm wall for 501RL	2.4 mm wall for 501RL2
Bioprene®	Bioprene® (excl. 0.5&0.8mm)
Marprene®	Marprene® (excl. 0.5&0.8mm)
Silicone	Silicone
Neoprene (excl. 0.5 mm)	Sta-Pure™ (excl. 0.5&0.8mm)
Butyl (excl. 0.5&0.8mm)	Chem-Sure™ (excl. 0.5&0.8mm)
Tygon® (excl. 0.5&0.8)	
Fluorel™ (excl. 0.5&0.8mm)	
Sta-Pure™ (excl. 0.5&0.8mm)	
Chem-Sure™ (excl. 0.5&0.8mm)	